

# MASIPALA WASE THEEWATERSKLOOF MUNISIPALITEIT

Munisipale Kantoor/Municipal Office  
Pleinstraat/Plein Street  
Posbus/P.O Box 24  
CALEDON  
7230



Tel. no.: 028 214 3300  
Faks/Fax no.: 028 214 1289  
E-pos/E-mail: [twkmun@twk.org.za](mailto:twkmun@twk.org.za)

Our Reference Number: FA/331 (and App Id: 3342)  
Your Reference Number:  
Enquiries: Sunet du Toit, 028 214 3300 / [sunetdu@twk.org.za](mailto:sunetdu@twk.org.za)

Date: 22 February 2021

## REGISTERED MAIL

GA Dennis  
Graham Dennis Land Surveyor  
39 Thornhill Road  
RONDEBOSCH  
7700

(Per E-mail: [gdsurv@iafrica.com](mailto:gdsurv@iafrica.com))

---

## DECISION LETTER TO APPLICANT

---

Dear Mr Dennis

### APPLICATION FOR SUBDIVISION - REGISTRATION OF A PIPELINE SERVITUDE: FARM 331 ANNEX KROM RIVER, CALEDON DISTRICT

1. This application received, 25 August 2020, refers.
2. The Authorised Employee, on 17 February 2021 **approved, in whole** your application for **Subdivision for the registration of a pipeline servitude**, in terms of section 60 of the Theewaterskloof Municipality: By-law on Municipal Land Use Planning, 2015.
3. **Reasons** for the above decision are as follows:
  - 3.1. The proposal will not negatively impact on the engineering services.
  - 3.2. The proposal conforms to forward planning documents.
  - 3.3. No change in land use is proposed and as a result the character of the surrounding area will remain unchanged.
  - 3.4. The proposal will result in the effective utilisation of existing resources in the area.
  - 3.5. Basic infrastructure will be provided as a result of the application.
4. **The abovementioned approval is subject to the following conditions in terms of Section 66 of the Theewaterskloof Municipality: By-law on Municipal Land Use Planning:**
  - 4.1. The approval is valid for 5 years, after the expiry of the period contemplated in Section 79(2), in terms of Section 22 of the Theewaterskloof Municipality: By-law on Municipal Land Use Planning (2015);

- 4.2. The 4m wide water pipeline servitude must be registered at the Deeds Registrar and Surveyor-General's Office within the validity period of this approval, generally in accordance with Plan Ref.: CLDN Servitude, drawn by: EB, dated: 22 July 2020;
  - 4.3. The approval of this application does not exempt the applicant/developer from compliance with any other legislation; and
  - 4.4. Any service upgrades required be for the cost of the owner/applicant.
5. You are hereby informed of your right to appeal to the Appeal Authority in terms of section 79(2) and 80 of the said legislation.
- 5.1. The attached appeal form must be completed and should be directed to the Appeal Authority and received by the Theewaterskloof Municipality, 6 Plein Street, Caledon, 7230 telephone: 028 214 3300, within 21 days of notification of this decision together with proof of payment of the appeal fee.
  - 5.2. You are requested to simultaneously serve notice of the appeal on any person who commented on the application and any other persons as the Municipality may determine (see attached list). Proof of serving the notification must be submitted to the Municipality, within 14 days of serving the notification.
  - 5.3. The notice must be served in accordance with section 35 of the said legislation and in accordance with the additional requirements as may be determined by the Municipality. The notice must invite persons to comment on the appeal within 21 days from date of notification of the appeal.
6. Kindly note that no appeal right exists in terms of Section 62 of the Local Government Municipal Systems Act, No 32 of 2000.

Yours faithfully

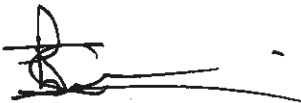

**JC PIENAAR**  
**MANAGER: TOWN PLANNING AND TOWN PLANNING**

**NOTES:**

1. Co-ordinate system: Hartebeesthoek 94/Lo19.
2. The line a b represents the north eastern boundary of a proposed Pipeline servitude 4m wide unless restricted by cadastral boundary over the farm Annex Krom River No 331.

**Munisipalek THREWATERSKLOOF Municipality**

Onderverdeling toegestaan ingevolge van Artikel 60 van die Verordening op Grondreghsbeplanning (PN 7429 van 20 Julie 2015), onderhewig aan voorwende.

Subdivisie granted in terms of Section 60 of the By-Laws on Municipal Land Use Planning (PN 7429 of 20 July 2015), subject to conditions.

Mun. Bestuurder/Manager

Date/Date

22/02/2021

Date: 22 July 2020 Ref: CLDN Servitude

Drawn by: EB

Checked by: GD SCALE: 1/7500 @ A3

**PROPOSED PIPELINE  
SERVITUDE OVER  
THE FARM  
ANNEX KROM RIVER NO 331**

PREPARED BY:

*Graban Dennis*  
Land Surveyor

39 THORNHILL ROAD  
RONDEBOSCH  
7700

Cell: 082-5796544  
E-mail: gdsurvey@africa.com

Cadastral, Sectional Title,  
Topographical & Engineering Surveyor

INSET 2  
SCALE 1/3000

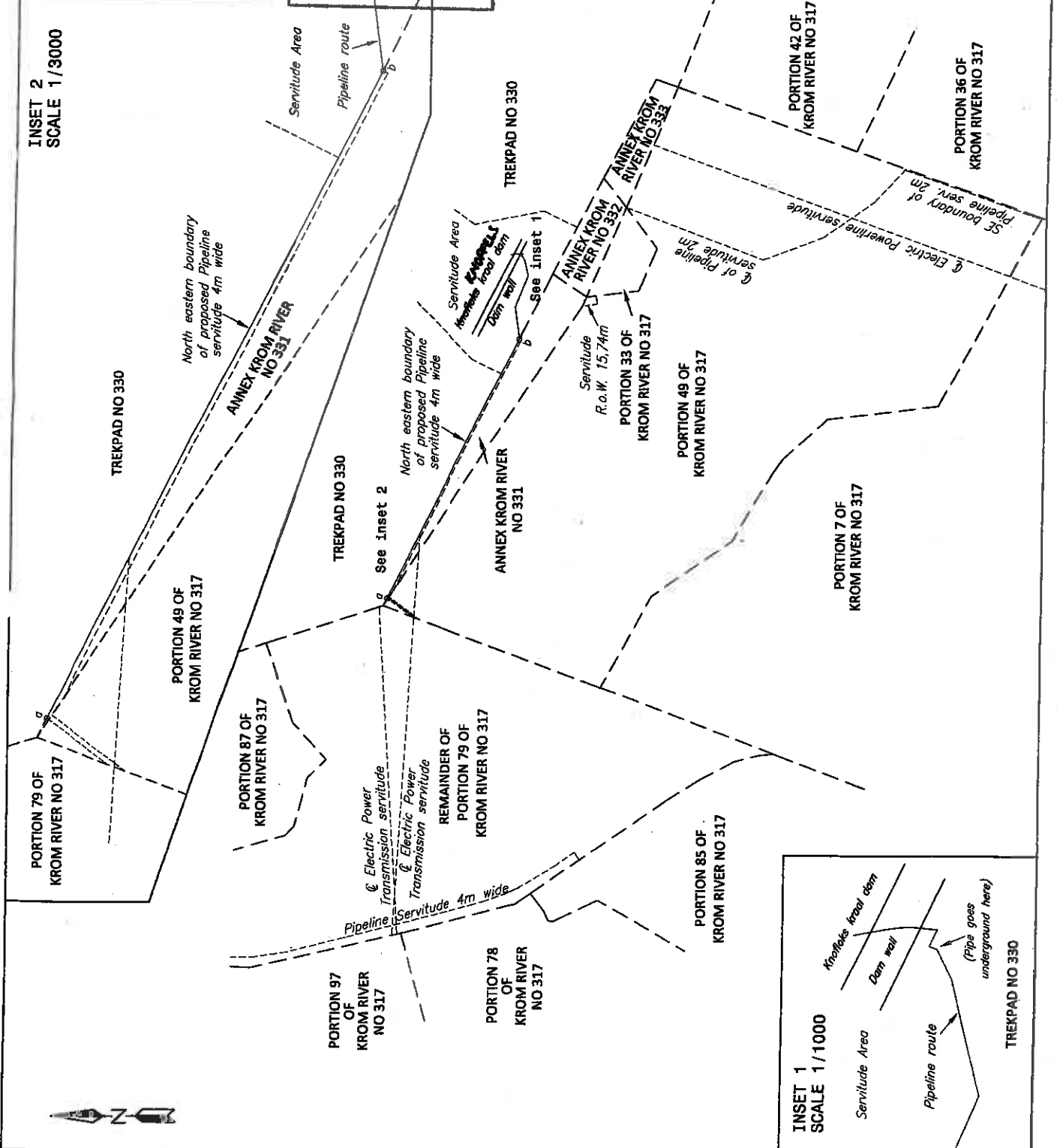

INSET 1  
SCALE 1/1000

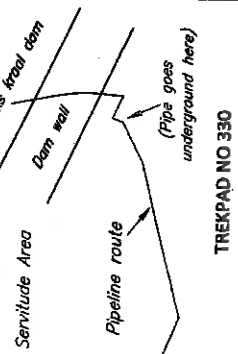

# MASIPALA WASE THEEWATERSKLOOF MUNISIPALITEIT

Munisipale Kantoor/Municipal Office  
 Pleinstraat/Plein Street  
 Posbus/P.O Box 24  
**CALEDON**  
 7230



Tel. no.: 028 214 3300  
 Faks/Fax no.: 028 214 1289  
 E-pos/E-mail: twkmun@twk.org.za

## APPEAL FORM

(Section 79 of the Proposed Standard Draft By-law on Municipal Land Use Planning)

**KINDLY NOTE:** Please complete this form using BLOCK capitals and ticking the appropriate boxes. Append this form to your letter of appeal which must comply with section 80 of the Theewaterskloof Sstandard By-law on Municipal Land Use Planning.

### PART A: APPEAL

Are you appealing against the decision made by the authorised employee or Tribunal?	Y	N	If Yes, indicate in Part E if the appeal is lodged against the whole decision or part thereof. If the latter applies provide a description of the part.
Are you appealing in respect of the failure of the authorised employee or Tribunal to make a decision within the period contemplated in section 57(1) or (2)?	Y	N	If Yes, provide facts that prove the failure in Part E.
Are you appealing against the condition(s) of approval imposed by the authorised employee or Tribunal?	Y	N	If Yes, list relevant condition(s) and provide a description in Part E.
Is your appeal based on and primarily concerned with the process followed prior to the authorised employee or Tribunal decision?	Y	N	If Yes, specify in Part E.
Is your appeal based on and primarily concerned with the merits of the land development or land use application on which it is believed that the authorised employee or Tribunal erred in coming to the conclusion?	Y	N	If Yes, specify in Part E.
Date of decision	DD/MM/YYYY	Date receiving notice of decision	DD/MM/YYYY
Who took the original decision?	<input checked="" type="checkbox"/>	Authorised employee	<input checked="" type="checkbox"/> Tribunal

### PART B: APPELLANT'S DETAILS

First name(s)	
Surname	

# MASIPALA WASE THEEWATERSKLOOF MUNISIPALITEIT

Munisipale Kantoor/Municipal Office  
 Pleinstraat/Plein Street  
 Posbus/P.O Box 24  
**CALEDON**  
 7230



Tel. no.: 028 214 3300  
 Faks/Fax no.: 028 214 1289  
 E-pos/E-mail: twkmun@twk.org.za

Company or legal person's name <i>(if applicable)</i>				
Postal address				Postal Code
Email				
Tel		Fax		Cell

**PART C: APPELLANT'S PROPERTY DESCRIPTION** *(Property that is affected by proposed development)*

Number(s) of Erf/Erven/Portion(s) or Farm(s), allotment area.				
Physical Address				
GPS Coordinates		Town/City		

**PART D: PROPERTY DESCRIPTION OF PROPOSED LAND DEVELOPMENT**

Number(s) of Erf/Erven/Portion(s) or Farm(s), allotment area.				
Physical Address				
GPS Coordinates		Town/City		

**PART E: APPEAL MOTIVATION AND REASONS\***

--	--	--	--	--

# MASIPALA WASE THEEWATERSKLOOF MUNISIPALITEIT

Munisipale Kantoor/Municipal Office  
 Pleinstraat/Plein Street  
 Posbus/P.O Box 24  
**CALEDON**  
 7230



Tel. no.: 028 214 3300  
 Faks/Fax no.: 028 214 1289  
 E-pos/E-mail: twkmun@twk.org.za

\* Appeal motivation, information and reasons may be attached.

## PART F: APPEAL FEE (for completion and use by official)

<b>Appeal</b>	R
<b>TOTAL APPEAL FEES*</b>	R

\* Appeal fees that are paid to the Municipality are non-refundable and proof of payment of the application fees must accompany the application.

## BANKING DETAILS

Name:

Bank:

Branch no.:

Account no.:

**Payment reference:** .....

(If applicable)

## PART G: ATTACHMENTS AND SUPPORTING INFORMATION AND DOCUMENTATION

Complete the following checklist and attach all the information and documentation relevant to the appeal.

Y	N	Proof of payment of appeal fees (applicant)	Y	N	Proof of serving notice of appeal (applicant)
Y	N	Copy of decision and proof of notification	Y	N	Copy of conditions of approval
Y	N	Motivation and reasons for appeal	Y	N	Other (specify)

## SECTION H: DECLARATION

I hereby wish to confirm the following :

- That the information contained in this appeal form and accompanying documentation is complete and correct.
- I'm aware that it is an offense in terms of section 85(1)(e) of the said legislation to supply particulars,

# MASIPALA WASE THEEWATERSKLOOF MUNISIPALITEIT

Munisipale Kantoor/Municipal Office  
Pleinstraat/Plein Street  
Posbus/P.O Box 24  
**CALEDON**  
7230



Tel. no.: 028 214 3300  
Faks/Fax no.: 028 214 1289  
E-pos/E-mail: twkmun@twk.org.za

information or answers knowing the particulars, information or answers to be false, incorrect or misleading or not believing them to be correct.

Appellant's signature: \_\_\_\_\_

Date: \_\_\_\_\_

Full name: \_\_\_\_\_

## FOR OFFICE USE ONLY

Date received: \_\_\_\_\_

Received by: \_\_\_\_\_

Munisipaliteit